

A1

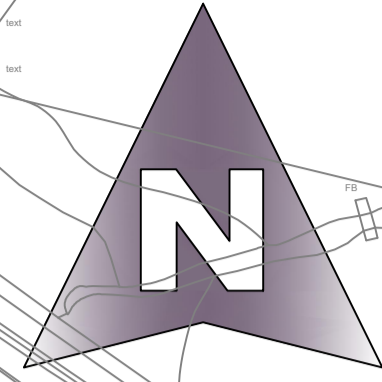
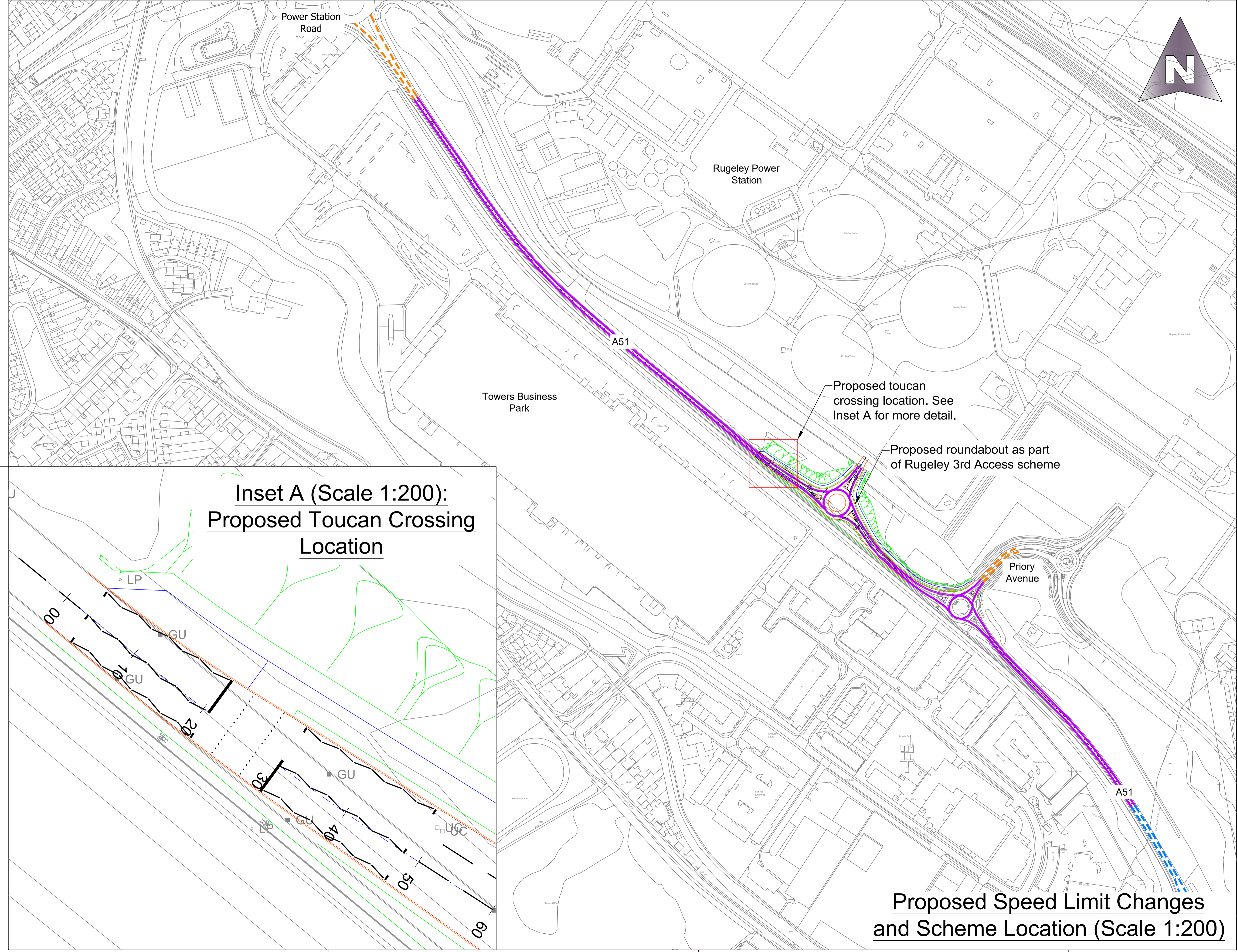

KEY

—	Existing 50mph to become 40mph
—	Existing 30mph
—	Existing 40mph

**Inset A (Scale 1:200):
Proposed Toucan Crossing Location**

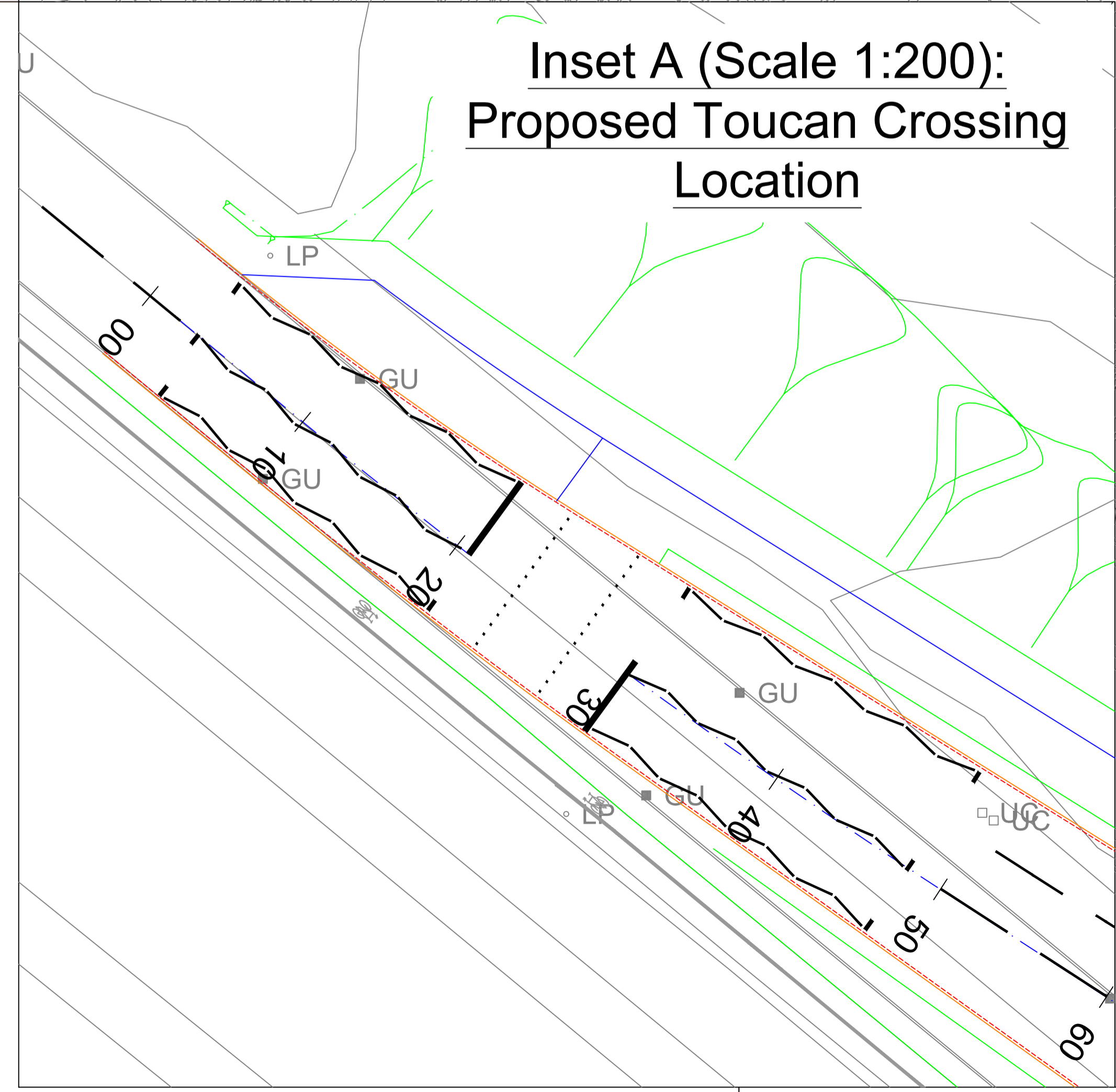

Proposed toucan crossing location. See Inset A for more detail.

Proposed roundabout as part of Rugeley 3rd Access scheme

Proposed Speed Limit Changes and Scheme Location (Scale 1:200)

R0	Original Drawing	RS	09/05/2024
Rev	Detail	By	Date

Revisions

Original Version	
Drawn: RS	
Design: TC	
Date: May 2024	Other

Checked by:

Approved by: (Drawing NOT approved if this box is empty)



Project Name	Rugeley 3rd Access
Drawing Title	Proposed TROs

Grid reference : 405459 317293
Original Drawing Size : A1 Dimensions : m
Scale : As Shown Copyright © Amey

Drawing No	D0240G-SK19-01	Rev	R0
------------	----------------	-----	----

Trim to this line for A1

File Name: J:\Highways\East\Schemes\5278 Rugeley 3rd Access - D0240G\CAD\Disciplines\WIP\1 Live Drgs\Schemes\00240G-SK19-01 - Proposed TRO.dwg
 Layout Name: D0240G-R00-03