

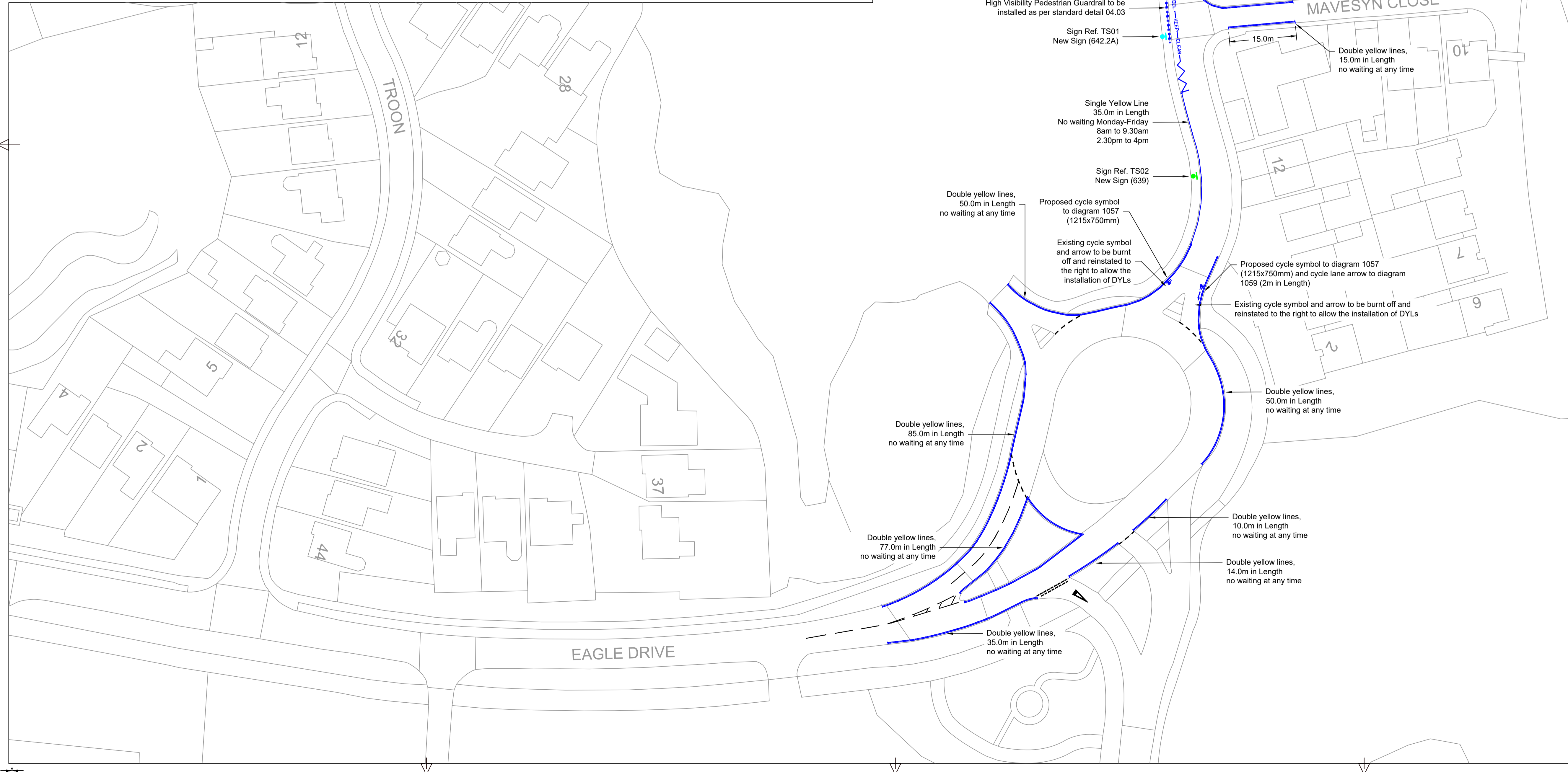

Not To Scale

Scheme Ref.		Scheme Ref.	
Sign Ref.	TS01	x-height	40.0
Letter colour	BLACK	SIGN FACE	
Background	YELLOW	Width	625 mm
Border	BLACK	Height	655 mm
Material	Class RA2 (12899-1:2007)	Area	0.41 m ²

Scheme Ref.		Scheme Ref.	
Sign Ref.	TS02	x-height	20.0
Letter colour	BLACK	SIGN FACE	
Background	YELLOW	Width	310 mm
Border	BLACK	Height	230 mm
Material	Class RA2 (12899-1:2007)	Area	0.07 m ²



Notes:

- 1 No. TS02 to be installed in accordance with HWD 12.54.1
- 1 No. TS01 and 1 No. TS02 to be installed on existing lighting columns
- Proposed Road markings to tie into existing road markings
- All traffic signs and road markings are in accordance with the Traffic Sign Regulations & General Directions 2016 and all subsequent amendments
- The carriageway is to be swept clear of all debris and spillages prior to application of thermoplastic material
- Proposed Double Yellow Lines, Single Yellow Lines and School Keep Clear Markings are to be 75mm thick and yellow in colour.
- Minimum mounting height from top of finished surface level to bottom of sign faceplate to be 2.3m
- All signs to be installed at the back of the existing footway, a minimum 450mm from the edge of the kerb to the leading edge of the sign faceplate
- Footway reinstatements to be comprised of permanent footway construction:
 - 20mm AC5 dense surf 100/150
 - 50mm AC20 dense surf 100/150
 - Minimum 100mm type 1 sub-base
 - Sub-base material can be used for the remainder of backfill in lieu of as-dug material if required. Compaction in 175mm lifts.
- Pedestrian guardrail to be set back from the kerb as follows:
 - Speed limit 30mph and below - 450mm

Key:

- Existing Road Markings
- New Double Yellow Lines 1018.1
- New School Keep Clear Marking 1027.1
- New Single Yellow Line 1017
- New cycle symbol 1057
- New cycle arrow 1059
- Proposed sign to be mounted to new post
- Proposed sign to be mounted to existing lighting column
- Proposed high visibility pedestrian guardrail

Rev	Detail	By	Date
R1	Addition of pedestrian guardrail at parent waiting zone, drawing note 10 and double yellow lines at eagle drive roundabout.	KM	02/08/2023
R0	Original drawing	KM	26/07/2023

Revisions

Original Version	
Drawn: KM	
Design: KM	
Date: July 2023	Other

Checked by:

Approved by: (Drawing NOT approved if this box is empty)



Project Name	Amington Primary School
Drawing Title	Traffic Signs & Road Markings

Grid reference : SK242036	Original Drawing Size : A1	Dimensions : m
Scale : 1:500	Copyright © Amey	

Drawing No	Rev
E1216L-R12-01	R1