

RESIDUAL DESIGN HAZARDS
 (The following information has been collected from Preconstruction Information and the Amey CDM Hazard Management Process.)

- Working in the vicinity of steep embankments
- Working in the vicinity of a live carriageway / public
- Working in proximity of overbridge and/or proposed retaining wall
- Working in vicinity of underground statutory undertakers

A1

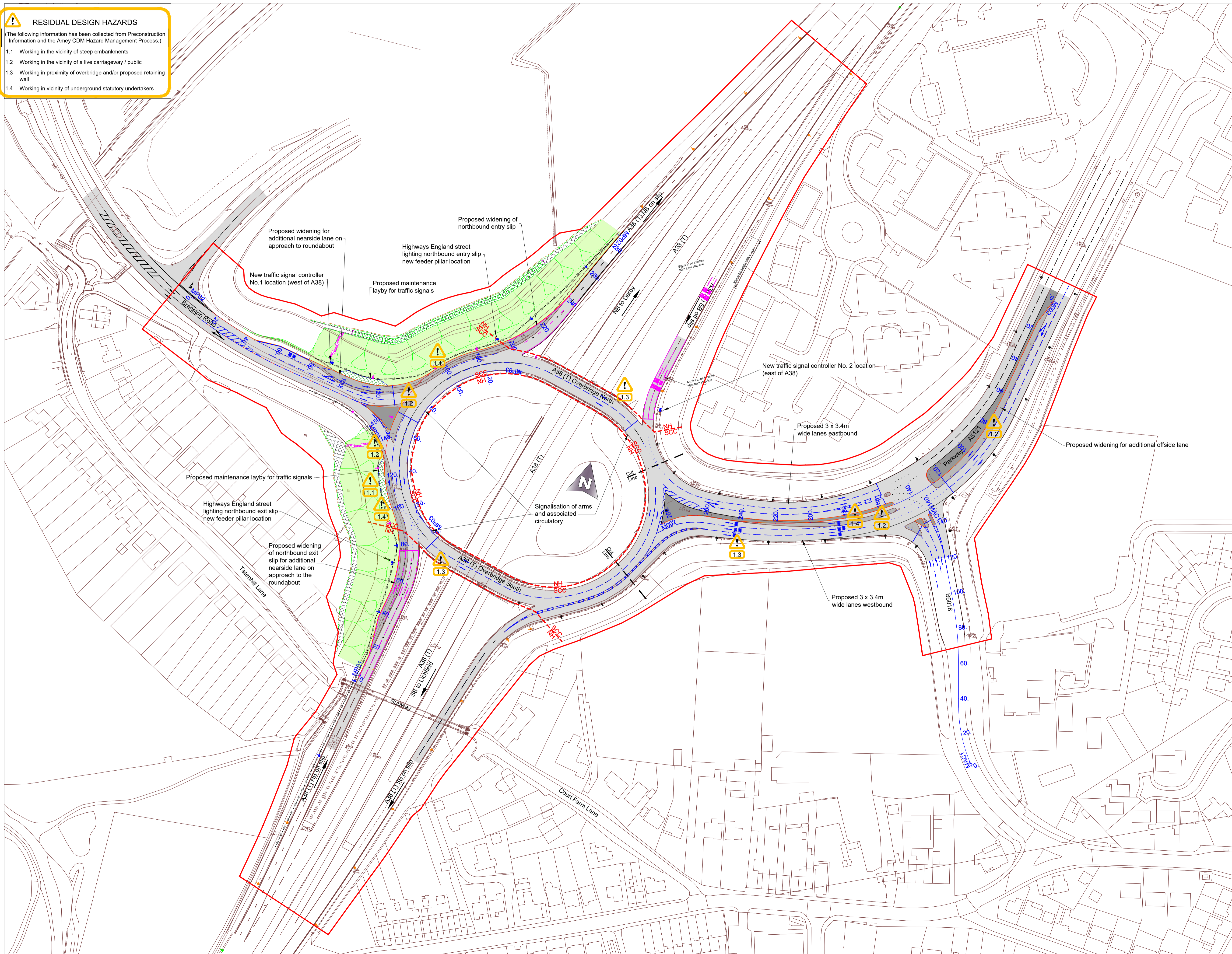

Notes
 1. All road markings are to be in accordance with Traffic Signs and General Directions 2016 and Traffic Signs Manuals.

Key

Existing:

- Existing carriageway
- Existing road markings

Proposed:

- Proposed carriageway widening
- Proposed Footway/central reserve
- Existing footway/hard standing to be replaced with carriageway
- Proposed Earthworks widening
- Proposed maintenance strip
- Proposed maintenance lay-by (grass-crete or similar)
- Proposed Carriageway edge
- Proposed Safety Barrier
- Proposed Road Markings
- Proposed Road Markings to be Methyl Methacrylate (MMA)
- Proposed Earthworks
- Proposed post and 4 rail fence to HCD H3
- Access Steps to HCD
- Proposed feeder pillar (Highways England street lighting)
- Proposed traffic signals controller
- Site boundary
- Staffordshire County Council/Highways England boundary
- Proposed lighting column (HE)
- Existing lighting column to have new lantern (HE)
- Proposed lighting column (SCC)
- Existing lighting column to have new lantern (SCC)

Rev	Detail	By	Date
R2	Target Cost Issue	DC	13/03/2023
R1	Revised road markings and VRS. Revised LC locations. Revised notes.	DC	13/06/2022
R0	Original drawing		

Revisions

Original Version	Preliminary	For target cost	For tender	For construction	As constructed	Other

Checked by: _____

Approved by: (Drawing NOT approved if this box is empty)



Project Name
A38 (T) Branston Interchange Improvement, Burton Upon Trent

Drawing Title
**HIGHWAYS
 General Arrangement**

Grid reference : 422 000, 321 200
Original Drawing Size : A1 Dimensions : m
Scale : 1/1000 Copyright © Amey

Drawing No D0216G-R01-01	Rev R2
------------------------------------	------------------